

Universal Filter Holding Frame - Installation Manual

Corner clip Installation

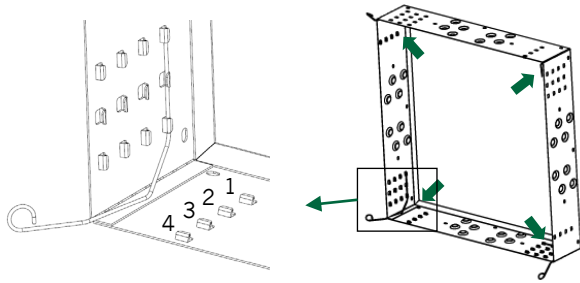

Assemble the clips in each corner of the frame. There are multiple positions to the corner clip enabling a variety of filter depths. It could be a header frame filter, panel filter or a combination thereof. Filter clamping settings for 25 (1), 50 (2), 75 (3) or 100 (4) mm filter depth.

Header Frame Filter Installation

Dust air side

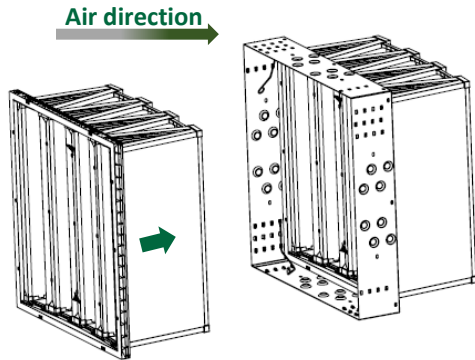

Clean air side

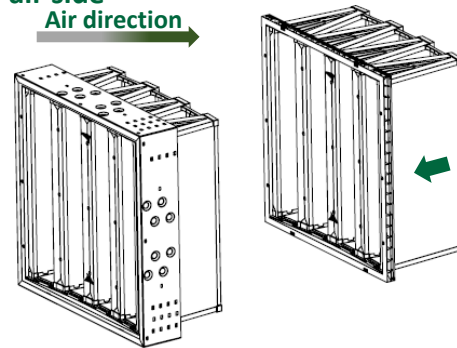

Installation of filter : place the filter against the gasket in the filter holding frame. Then lock the corner clips so that the gasket is compressed against the frame.

Prefilter Installation

Dust air side

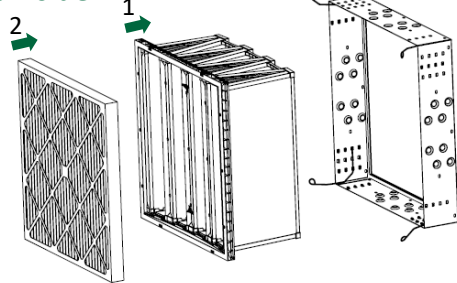

Clean air side

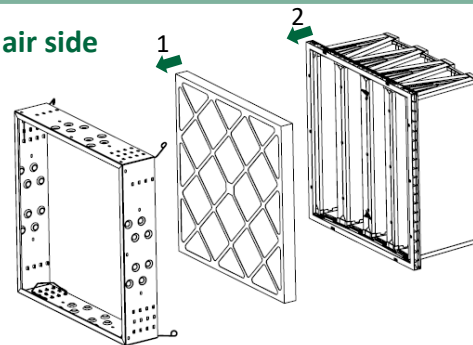

When installing a combination of filters make sure to adjust the clips to fit the combined filter depth. Note that the service side determines in which order the filters are being installed.

Bank Installation

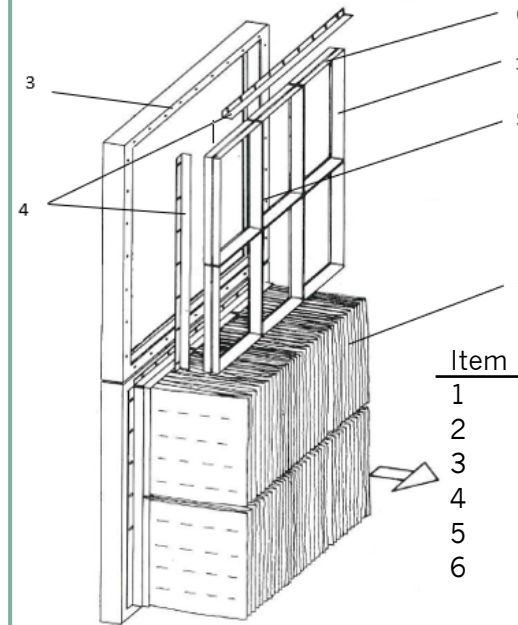

Item	Description
1	Filter Holding Frame
2	Bag filter
3	RZA mounting frame
4	MZA mounting bar
5	ZWB stiffener bar
6	Sealing material

The service side is determined acc. to the installation design (dust or clean air side). Install fasteners in all mounting holes off the filter holding frame utilizing M5x10 screws, M5 nuts and washers or rivets to form a vertical stack of frames.

Gasket or proper sealant is required between all joints to prevent air bypass, including frame connections and duct integrations.

Stiffener bars (item 5) should be added between every vertical stack on banks 4 high x 3 wide and larger. The stiffener bar is screwed onto the frame stack.

The mounting bars (item 4) are screwed all around the finalized framework of the filter holding frames. All screws pointing outwards.

The pre-assembled framework is mounted onto the RZA frame (item 3) utilizing M8x20 screws and washers. Ensure proper sealing between framework and the RZA frame. If RZA frames are connected to one another, a suitable sealing material should also be applied between the frames in order to avoid any leaks.